

19 發展項目中的建築物的橫截面圖

Cross-section Plan of Building in the Development

A 座 Block A

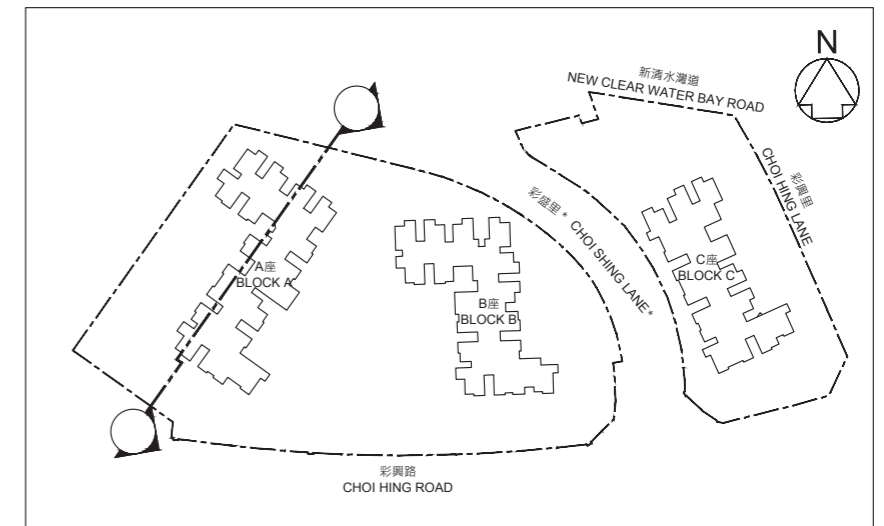
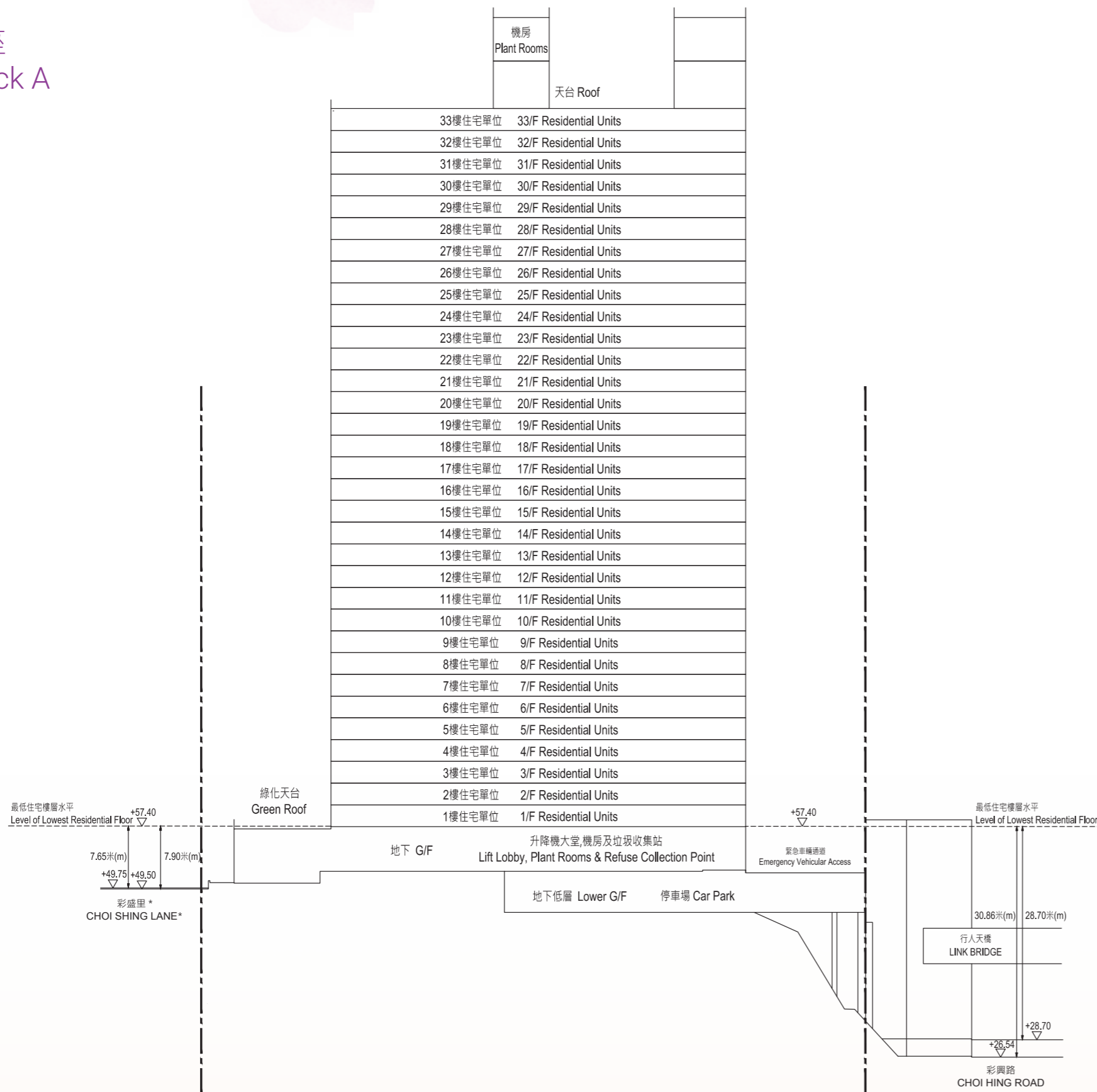

指示圖 KEY PLAN

(1) 毗連建築物(A座)的一段彩興路為香港主水平基準以上26.54米至28.70米。

The part of Choi Hing Road adjacent to the building (Block A) is from 26.54 metres to 28.70 metres above the Hong Kong Principal Datum.

(2) 毗連建築物(A座)的一段通往彩盛里*為香港主水平基準以上49.50米至49.75米。

The part of Choi Shing Lane* adjacent to the building (Block A) is from 49.50 metres to 49.75 metres above the Hong Kong Principal Datum.

* 此乃臨時街道名稱，有待政府公告確認。

The street name is provisional and is subject to confirmation by Government Notice.

圖例 NOTATION

--- 發展項目的邊界	Boundary Line of the Development
▽ 香港主水平基準上高度(米)	Height (in metres) above the Hong Kong Principal Datum

B 座
Block B

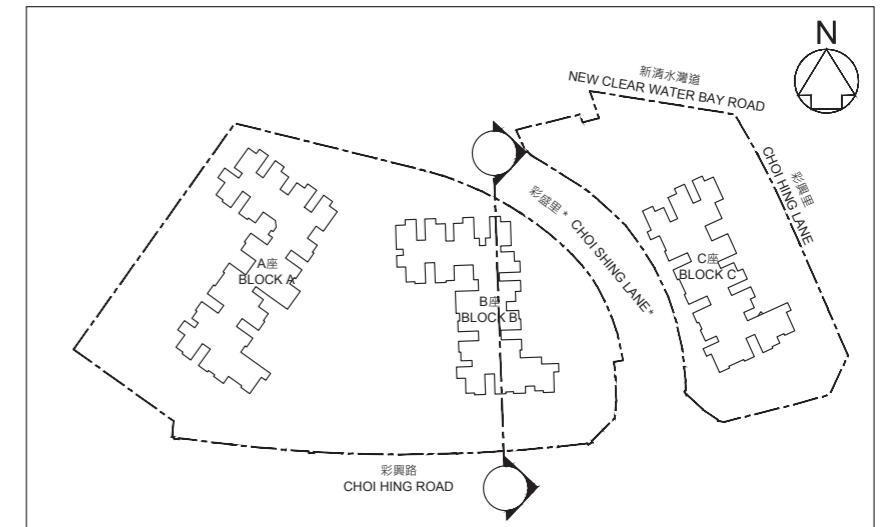
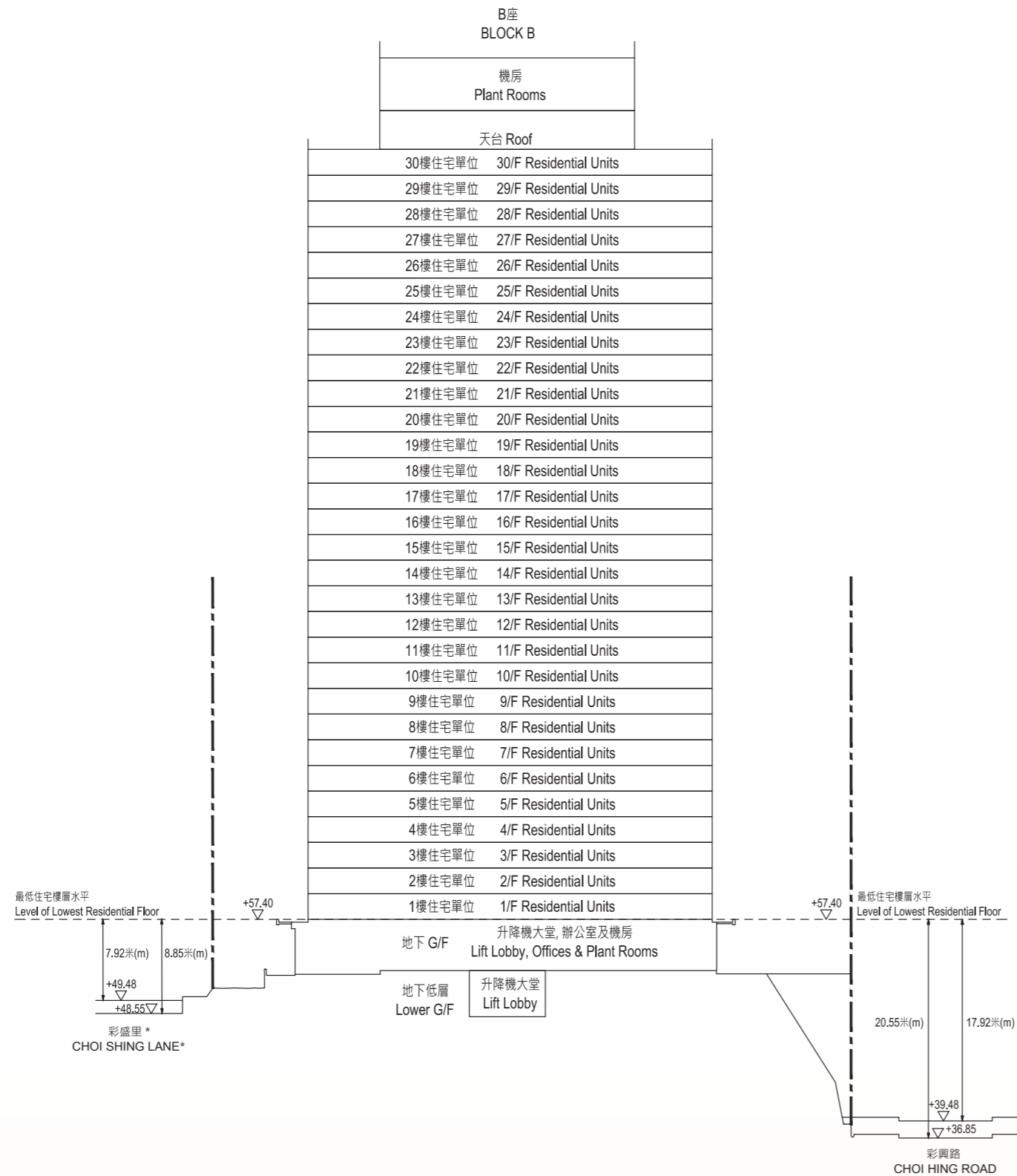

指示圖 KEY PLAN

(1) 毗連建築物(B座)的一段彩興路為香港主水平基準以上36.85米至39.48米。

The part of Choi Hing Road adjacent to the building (Block B) is from 36.85 metres to 39.48 metres above the Hong Kong Principal Datum.

(2) 毗連建築物(B座)的一段通往彩盛里*為香港主水平基準以上48.55米至49.48米。

The part of Choi Shing Lane* adjacent to the building (Block B) is from 48.55 metres to 49.48 metres above the Hong Kong Principal Datum.

* 此乃臨時街道名稱，有待政府公告確認。

The street name is provisional and is subject to confirmation by Government Notice.

圖例 NOTATION

-----	發展項目的邊界	Boundary Line of the Development
▽	香港主水平基準上高度(米)	Height (in metres) above the Hong Kong Principal Datum

B 座
Block B

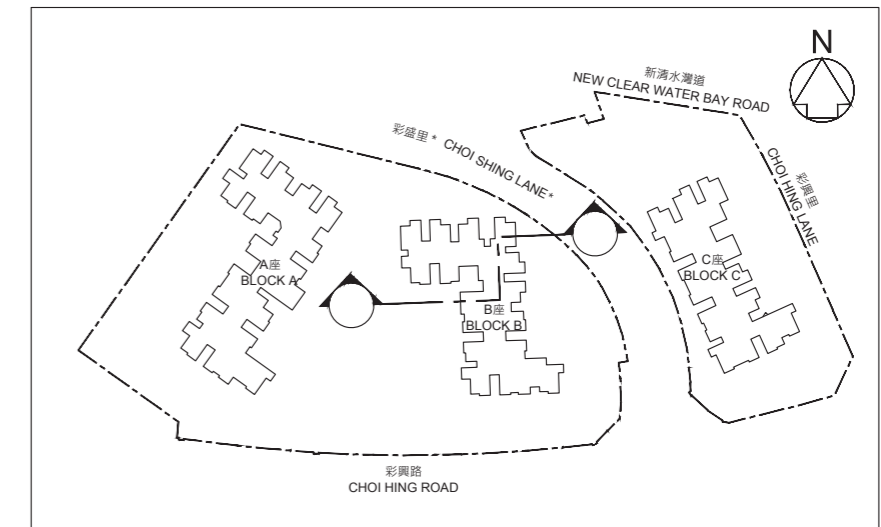
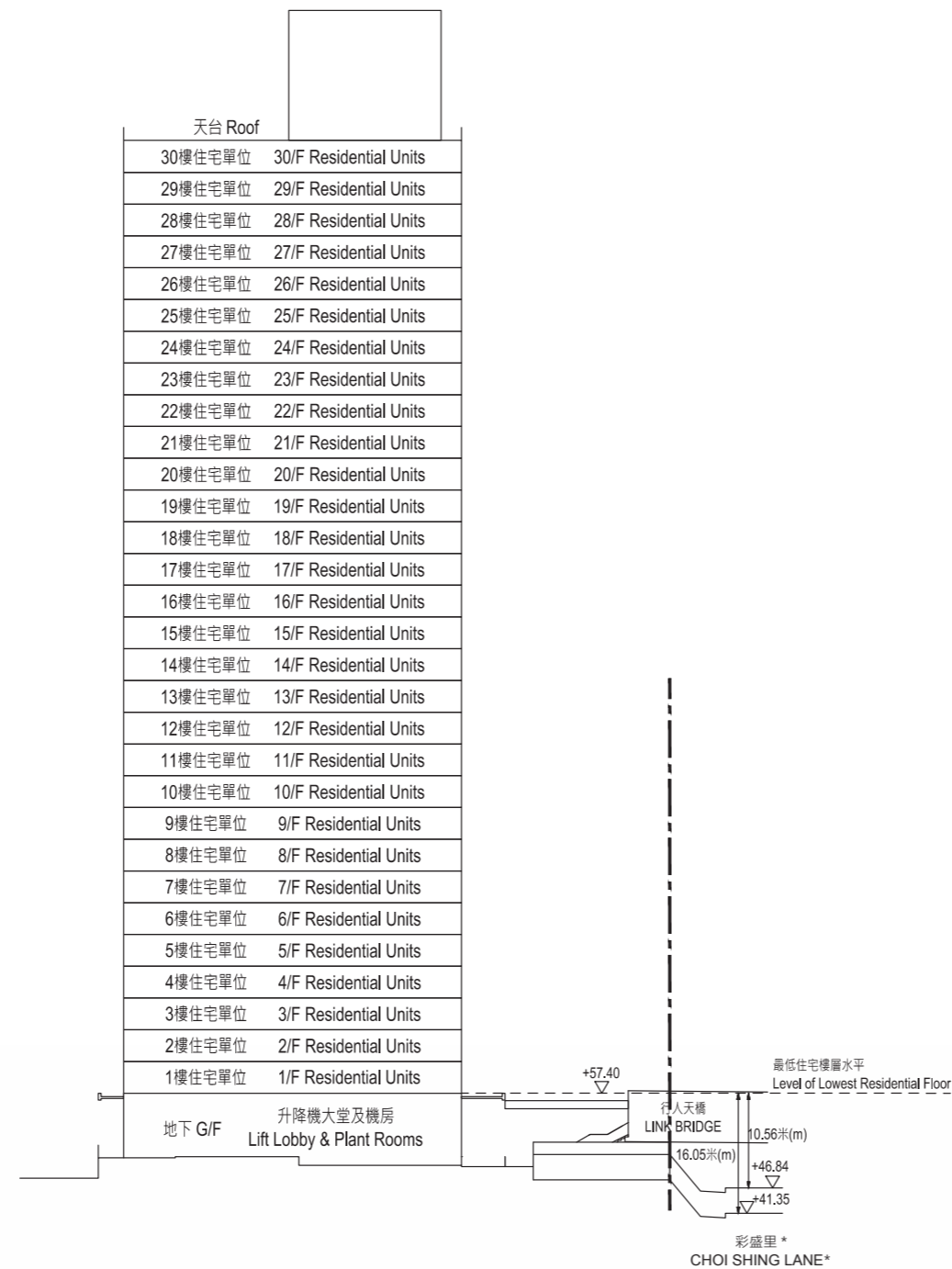

指示圖 KEY PLAN

毗連建築物(B座)的一段通往彩盛里*為香港主水平基準以上41.35米至46.84米。

The part Choi Shing Lane* adjacent to the building (Block B) is from 41.35 metres to 46.84 metres above the Hong Kong Principal Datum.

* 此乃臨時街道名稱，有待政府公告確認。

The street name is provisional and is subject to confirmation by Government Notice.

圖例 NOTATION

-----	發展項目的邊界	Boundary Line of the Development
▽	香港主水平基準上高度(米)	Height (in metres) above the Hong Kong Principal Datum

C 座
Block C

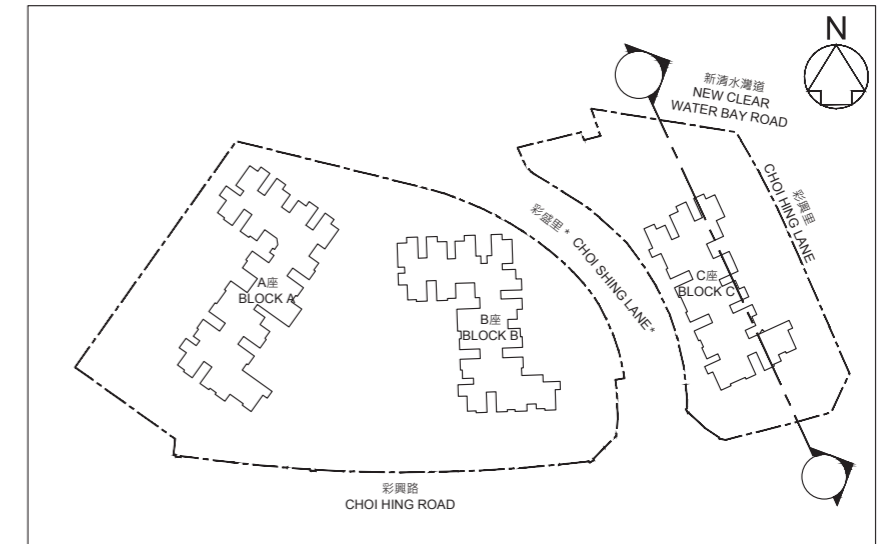
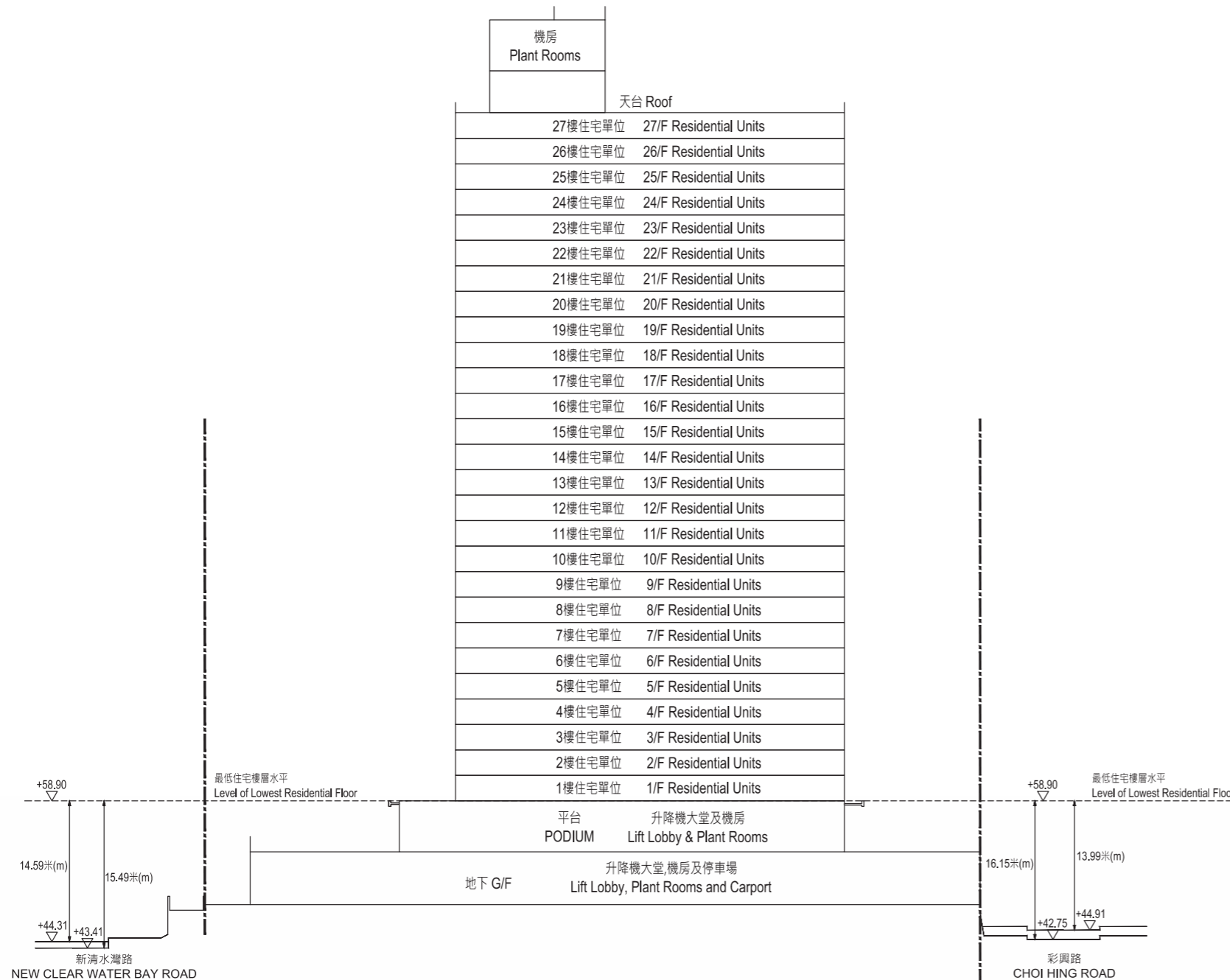

指示圖 KEY PLAN

- (1) 毗連建築物(C座)的一段彩興路為香港主水平基準以上42.75米至44.91米。
The part of Choi Hing Road adjacent to the building (Block C) is from 42.75 metres to 44.91 metres above the Hong Kong Principal Datum.
- (2) 毗連建築物(C座)的一段通往新清水灣道為香港主水平基準以上43.41米至44.31米。
The part of New Clear Water Bay Road adjacent to the building (Block C) is from 43.41 metres to 44.31 metres above the Hong Kong Principal Datum.

* 此乃臨時街道名稱，有待政府公告確認。
The street name is provisional and is subject to confirmation by Government Notice.

圖例 NOTATION

--- 發展項目的邊界	Boundary Line of the Development
▽ 香港主水平基準上高度(米)	Height (in metres) above the Hong Kong Principal Datum

C 座
Block C

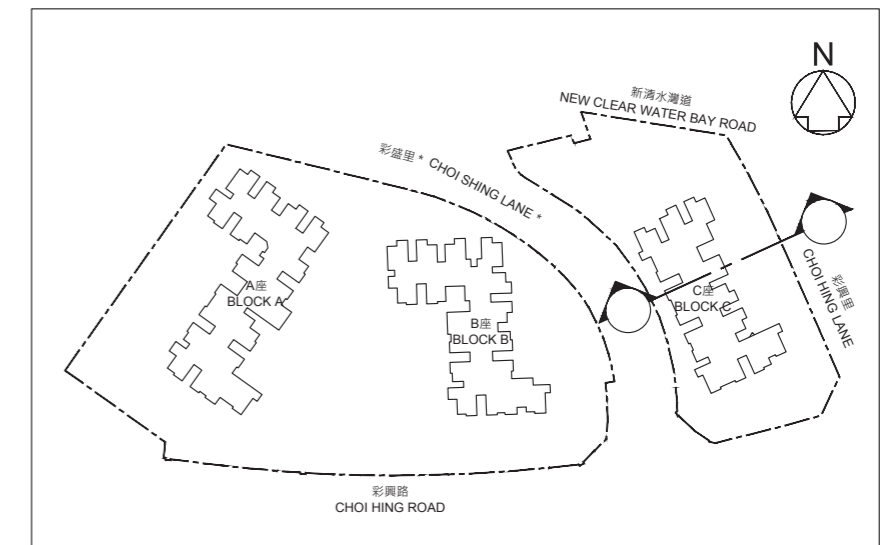
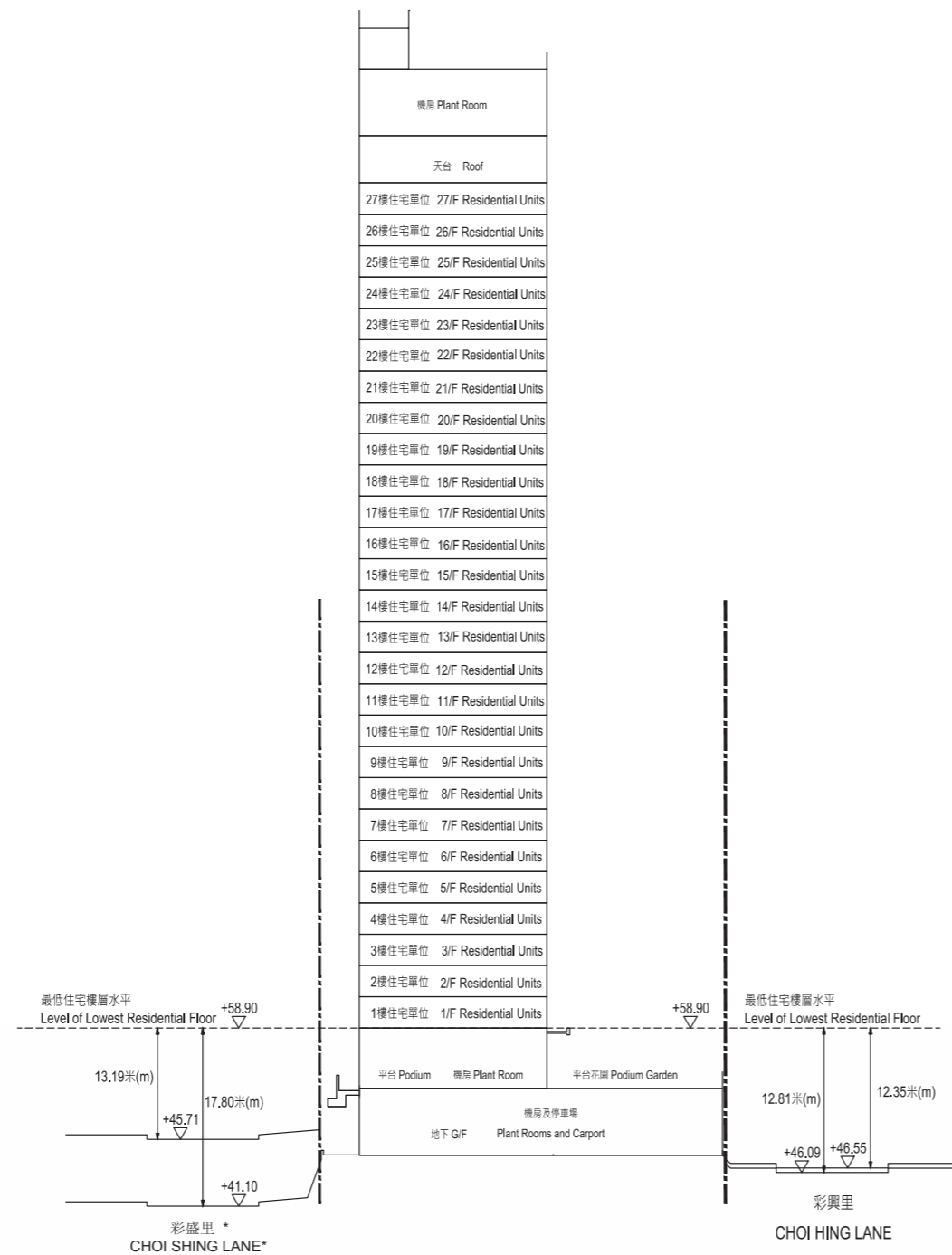

指示圖 KEY PLAN

(1) 毗連建築物(C座)的一段彩興里為香港主水平基準以上46.09米至46.55米。

The part of Choi Hing Lane adjacent to the building (Block C) is from 46.09 metres to 46.55 metres above the Hong Kong Principal Datum.

(2) 毗連建築物(C座)的一段通彩盛里*為香港主水平基準以上41.10米至45.71米。

The part of Choi Shing Lane* adjacent to the building (Block C) is from 41.10 metres to 45.71 metres above the Hong Kong Principal Datum.

* 此乃臨時街道名稱，有待政府公告確認。
The street name is provisional and is subject to confirmation by Government Notice.

圖例 NOTATION

--- 發展項目的邊界	Boundary Line of the Development
▽ 香港主水平基準上高度(米)	Height (in metres) above the Hong Kong Principal Datum